

DELTA® protects property. Saves energy. Creates comfort.

TECHNICAL DATA SHEET

DELTA®-FOOTING BARRIER

Capillary Barrier Membrane for Footing-to-Wall Transition.

MATERIAL

DELTA®-FOOTING BARRIER is a 3-ply sheet membrane consisting of a polyester needle-punched fabric, a polyethylene barrier, and an anti-slip surface layer. The specially designed, hydrophilic needle-punched PET fabric forms a strong mechanical bond with the concrete. It resists tearing during placement of gravel. The polyethylene middle layer creates a positive moisture barrier to prevent the wicking of water from the footings to the foundation walls. With a non-slip surface coating, DELTA®-FOOTING BARRIER helps keep the jobsite a safe place to work.

PROPERTIES

DELTA®-FOOTING BARRIER acts as a physical barrier, resisting the capillary wicking of water and upward migration of moisture from the footings into the foundation wall that is also known as rising damp. The material is designed to adhere well to the concrete footing. It is very pliable, allowing the forming of a keyway as per common practice, and can be easily installed by just one person.

APPLICATION

DELTA®-FOOTING BARRIER is laid into the freshly poured concrete footings, smoothed into place with a trowel, and the keyway is formed with the membrane in place. DELTA®-FOOTING BARRIER has a center line to mark the location of the keyway preprinted on it to make the alignment on the footing simple. Rebar may be inserted into the wet concrete through an X-cut in the DELTA®-FOOTING BARRIER. Forms for the foundation walls are placed and the concrete is poured normally.

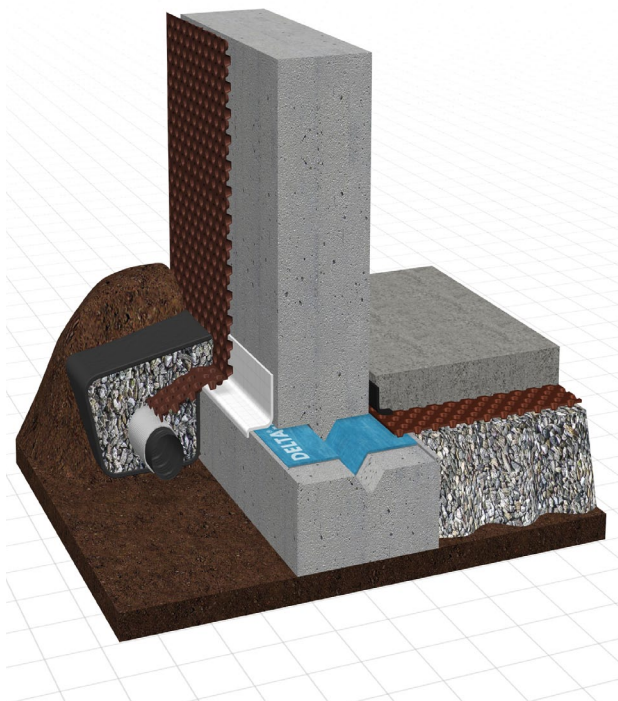

Technical Data

Product name	DELTA®-FOOTING BARRIER	
Color	Blue, with grey substrate	
Material	PET substrate with special polymeric coating and PP spunbonded finish	
Thickness	approx. 45 mils (1.2 mm)	
Water vapor transmission	5.8 g/m²/24 h	ASTM E96-05, Proc. A
	7.8 g/m²/24 h	ASTM E96-05, Proc. B
Permeance	0.8 perms [grains/h/ft²/in Hg]	ASTM E96-05, Proc. A
	1.1 perms [grains/h/ft²/in Hg]	ASTM E96-05, Proc. B
Tensile strength	MD: 32.2 lb/in	ASTM D882-02
	XD: 9.66 lb/in	
Elongation	MD: 65.4 %	ASTM D882-02
	XD: 130.3 %	
Impact resistance	1497 g	ASTM E1709-04, Meth. B
Resistance to water penetration	86.3 cm	ISO 811 - 1981
Flexural rigidity	MD: 9.9 µjoule/m (Bending Length = 68 mm)	ASTM D1388-07a
	XD: 2.2 µjoule/m (Bending Length = 41 mm)	
Peel adhesion - Concrete (average strength over 60 s)	7.9 lb/in (1,381 N/m)	ASTM C794-06
Temperature range	Suitable under normal concrete (working) temperature	
Toxicity	non-toxic, non-polluting	
Roll width	approx. 18" (45 cm)	
Roll length	82' (25 m)	
Service life expectancy	> 25 years (at temperature < 77°F / 25°C). Do not expose to UV light for more than 30 days.	

DELTA® products support sustainable and energy-efficient building practices, including efforts toward achieving LEED® certification (LEED® for New Construction & Major Renovations, LEED® for Core and Shell, LEED® for Existing Buildings and LEED® for Homes).

For technical support, call our technical support team at 1-888-4DELTA4 (1-888-433-5824) extension 326, or visit www.cosella-dorcken.com.

Cosella-Dörken Products Inc. 4655 Delta Way Beamsville, Ontario L0R 1B4

1-888-4 DELTA 4, (905) 563-3255 Fax: (905) 563-5582

info@cosella-dorcken.com, www.cosella-dorcken.com

A company of the Dörken Group